



BALLYMUN

REGENERATION NEWS

March/April 2001 Issue 21

MAIN STREET SPECIAL EDITION

INSIDE

- **Map of Main Street showing new buildings, pedestrian routes, traffic routes, new roads, etc.**
- **Main Street works schedule**



MAIN STREET UNDERWAY

If you have concerns about health & safety issues, please contact the Project Health & Safety Monitor, John Rizzolo at Ballymun Regeneration Ltd 8421144

We're building a fabulous new Main Street in Ballymun with all the facilities of a modern town - offices, hotel, leisure centre, arts centre, civic buildings, shops and housing. The new 1km Main Street stretches from the Ballymun Road/Santry Avenue junction to the Ballymun Road/Shanliss Avenue junction. It will transform the area in the long-term and everybody will benefit.

- The dual-carriageway is being replaced by an attractive, extensively landscaped, pedestrian prioritised street.
- A Quality Bus Corridor (QBC) will be put in place, to be replaced by the LUAS light rail line when it comes on stream in a couple of years.
- There will be jobs for local people in the new businesses and other facilities.

People from outside the area will come to Ballymun to live, shop, socialise and conduct business, which will boost the local economy.



continued back page

Ballymun's new MAIN STREET

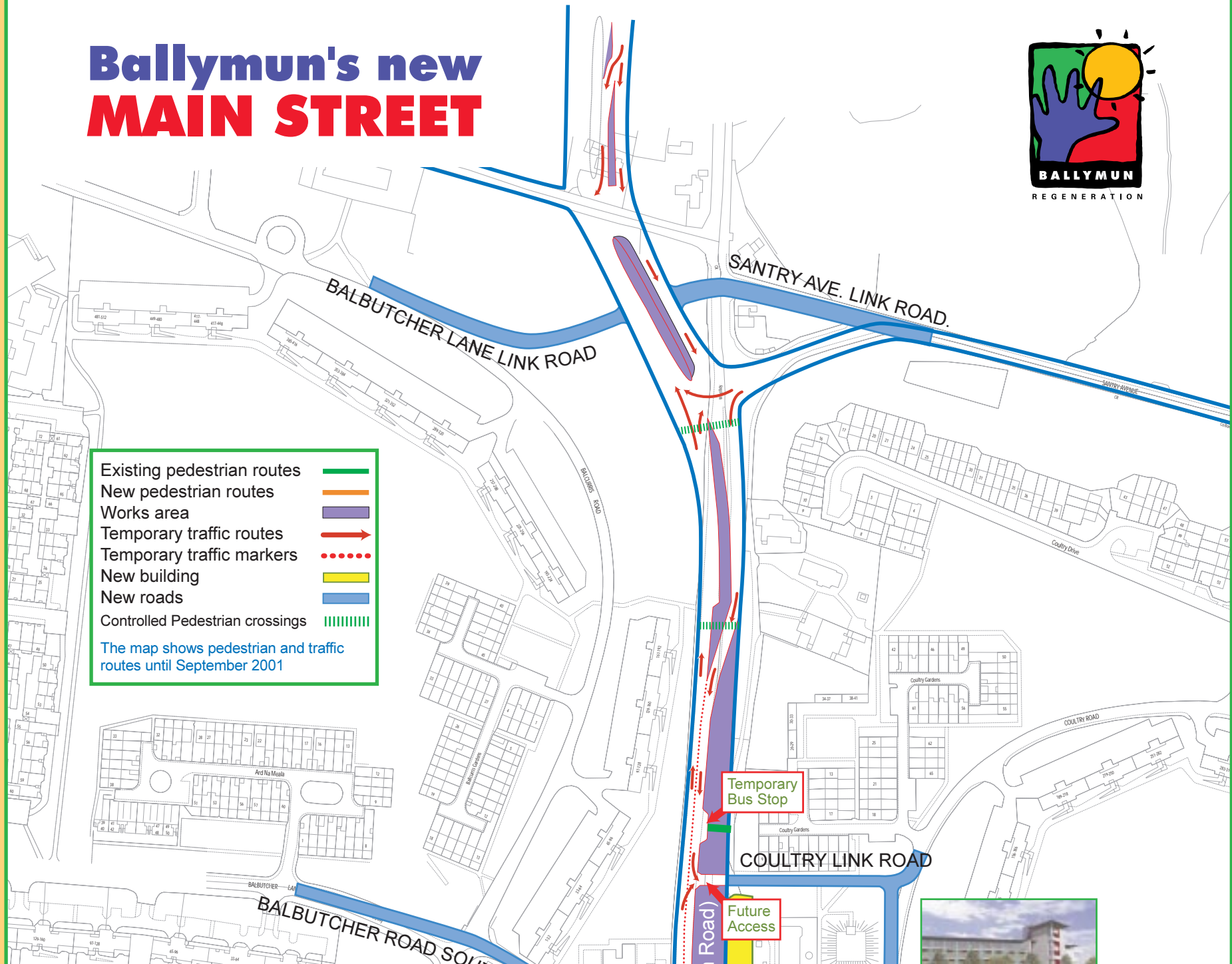

Existing pedestrian routes	
New pedestrian routes	
Works area	
Temporary traffic routes	
Temporary traffic markers	
New building	
New roads	
Controlled Pedestrian crossings	

The map shows pedestrian and traffic routes until September 2001

Temporary Bus Stop

Future Access



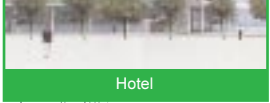
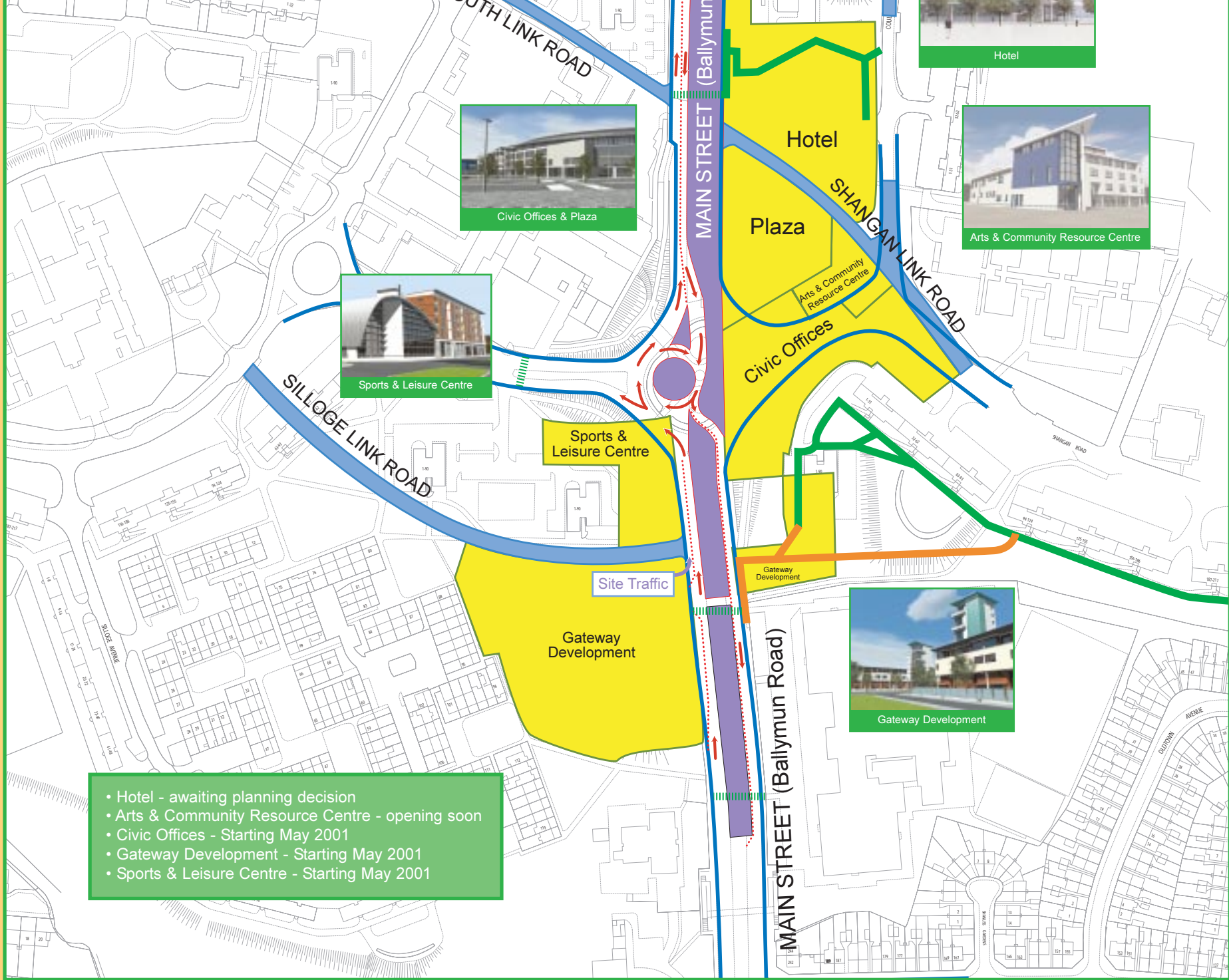

Hotel

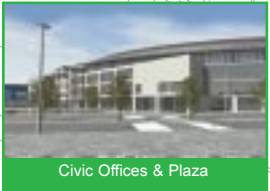

Civic Offices & Plaza



Arts & Community Resource Centre



Sports & Leisure Centre

Sports & Leisure Centre



Gateway Development

Gateway Development

Site Traffic

Gateway Development

- Hotel - awaiting planning decision
- Arts & Community Resource Centre - opening soon
- Civic Offices - Starting May 2001
- Gateway Development - Starting May 2001
- Sports & Leisure Centre - Starting May 2001

Main Street works schedule

BALLYMUN ROAD - SOUTHBOUND CARRIAGEWAY 13TH MARCH - SEPTEMBER 2001

- New Surface Drainage Sewer in Carriageway
- New Gas and Water Services in Carriageway
- New Telecommunication, Water, Gas, Public Lightning & ESB under the Footpath
- Realignment of the Carriageway crossing including Traffic Calming Measures
- New Pedestrian Cross including Traffic Calming Measures

BALLYMUN ROAD - NORTH BOUND CARRIAGEWAY SEPTEMBER 2001 - APRIL 2002

- New Foul Drain in Carriageway
- New Water Service in Carriageway
- New Telecommunication, Water, Gas, Public Lightning & ESB under the Footpath
- Realignment of the Carriageway and Footpath
- New Pedestrian Cross including Traffic Calming Measures

MAIN STREET/COULTRY LINK ROAD MARCH - JUNE 2001

- New Foul Drain in Carriageway
- Gas, Water, ESB and Telecommunications services under the Footpath
- New Road and Footpaths

SHANGAN ROAD DIVERSION MAY - OCTOBER 2001

- New Foul and Storm Drainage under the Carriageway
- New Gas, Water, ESB and Telecommunication services under the Footpath
- New Shangan Link Road and Footpaths from Shangan Road to Main Street including New Junction

BALBUTCHER ROAD SOUTH AUGUST - OCTOBER 2001

- New Storm and Foul Drainage in the Carriageway
- New Gas, Water, ESB and Telecommunication services under the Footpath
- New Junction from Balbutcher Lane to Santry Avenue

BALBUTCHER LANE AND SANTRY ROAD LINK SEPTEMBER - MAY 2002

- New Storm and Foul Drainage in the Carriageway
- New Gas, Water, ESB and Telecommunication services under the Footpath
- New Junction from Balbutcher Lane to Santry Avenue

SILLOGUE ROAD LINK AND SILLOGUE AVENUE JULY 2001 - MAY 2002

- New Gas, Water, ESB and Telecommunication services under the Footpath
- New Storm and Foul Drainage in the Carriageway
- New Road and Footpath

This schedule shows the proposed work programme for the Main Street construction and may change as the work progresses.

continued from page 1

PJ Carey Contractors Limited started construction work on the Main Street in March. The most noticeable change to the landscape so far has been the filling in of the old roundabout, this work is creating new sites for the new buildings on the Main Street.

"There will be delays during construction but we are

confident that motorists and pedestrians will be patient while we create the best planned and most exciting Main Street in Ireland," says Ciaran Murray, Managing Director. "Ballymun Main Street will be the focal point of the new town and putting it in place is going to take time."

Ballymun Regeneration Ltd (BRL) Stormanstown House Ballymun Road Dublin 9
ph: 8421144 fax: 8421443 E-mail: brl@brl.ie <http://www.brl.ie>



A Dublin Corporation Initiative